

Consultation on new neighbourhoods

The LLDC and property developer Ballymore have established a partnership to create outstanding communities in Stratford Waterfront and Bridgewater Triangle.

These neighbourhoods will be located in the south of the Park and aim to deliver exemplary design with around 1,200 new homes. 35% of the housing on Stratford Waterfront will be classed as affordable and 50% of housing on Bridgewater will be classed as affordable.

This project aims to be a model for sustainable development in London for the future.

Both projects have been granted 'Outline Planning'

permission, which means the general principles have been agreed.

The projects are now moving into a more detailed design stage, in which 'Reserved Matters' applications are being prepared for the sites. This is a process to agree on the design detail with the Local Planning Authority.

As part of this, there is an opportunity for you to shape the proposals and we would love to hear your thoughts. Our next community engagement event on Stratford Waterfront will be taking place on Saturday 13th May on the Park.

Find out more about the consultation and have your say here: stratfordnewneighbourhoods.com

Get your fingers green at the Mobile Garden

Mobile Garden is a community growing space where local residents, schools and community groups can come and connect with nature in the middle of Hackney Wick. Come and join one of our gardening sessions to learn food growing and garden care.

There are three sessions taking place each week, led by a team of Community Gardeners. The activities are free and suitable for all ages and levels of experience, and include sessions on growing food for people and wildlife and on creating garden infrastructure for biodiversity.

Please wear closed toe shoes and sensible clothes that you don't mind getting mucky. All equipment and tools are provided (shoes are not provided). The site is wheelchair accessible.

Visit: ourparklife.co.uk/mobile-garden-at-hackney-bridge/



The Great Get Together is back!

Save the date! The Great Get Together, a fabulous, free community celebration is back and will take place on Saturday 1st July.

The Great Get Together is inspired by and showcases the best of east London, bringing together music, dance, arts, sports and food for everyone to enjoy.

This year there will be a number of community organisations and groups delivering activities and



performing on the stages. The ever-popular East Bank Zone, in collaboration with industry-leading East Bank partners, will return with a range of fun and engaging activities for all the family to take part in.

Whether you want to be entertained, get creative or get up and take part - come along with your family and friends!

The event is supported by Foundation for Future London's Westfield East Bank Creative Futures Fund, funded by Westfield Stratford City, and the Foundations Programme, co-funded by City of London.

Improvements to Stratford Walk

The entrance to the Park from Endeavour Square is changing as new landscaping, benches and lighting are installed. Stratford Walk is part of the preparation for East Bank which will start to open later in 2023.

Daytime pedestrian access will be maintained at all times, but there may occasionally be overnight closures as part of the programme.

The work includes the replacement of the lift outside the London Aquatics Centre. This is expected to start on 17th April and last until June. Please follow the diversion route across Thornton Bridge for step free access.

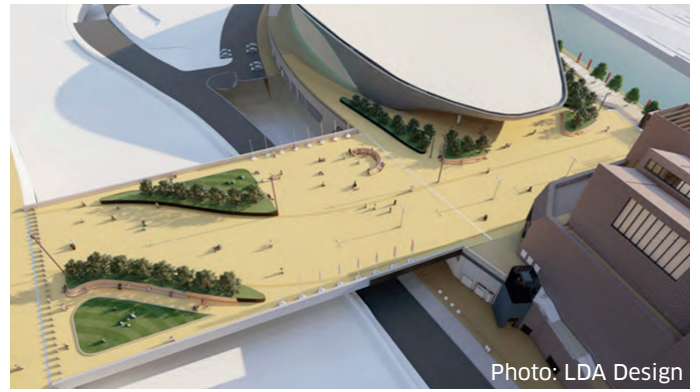

Photo: LDA Design

WHAT'S ON AT THE PARK

For more information and new event announcements, visit [QueenElizabethOlympicPark.co.uk/events](https://www.queenelizabetholympicpark.co.uk/events)

APRIL

ABBA Voyage (Thursday-Monday each week, plus extra Easter Monday show)	1
Tony n Tina's Wedding (Friday-Sunday each week)	2
15 WBO Championship Boxing	3
16 London Lions v Newcastle Eagles; London Lions v Leicester Riders	3
16 West Ham v Arsenal	9
21 London Lions v Plymouth City Patriots	3
21 Lee Valley VeloPark Run	7
22-23 EA Sports FIFA Global Series eChampions League	5
26 West Ham v Liverpool	9

MAY

ABBA Voyage (Thursday-Monday each week, plus extra Bank Holiday shows 01, 05, 08 & 28 & 31)	1
Tony n Tina's Wedding (Thursday-Sunday each week)	2
02-07 Riot League of Legends Play In Stage	3
03 Chase The Sun	10
06 West Ham v Manchester United	9
06 QEOP 5K/10K	10
09-14 Riot League of Legends Bracket Stage	3

18 Great Willy Waddle charity event	10
20 West Ham v Leeds United	9
21 Hackney Half*	11
21 Riot League of Legends Final	3
25 Futures For Kids Run	10
26 FIH ProLeague England v China Men	6
27 FIH ProLeague England v India Men	6
27 London Pulse v Loughborough Lightning	3
27-29 AP Race London International	8
28 FIH ProLeague England v Belgium Men	6
28 Ride London*	11
30 UK Open Pool Championship	3

JUNE

ABBA Voyage (Thursday-Monday each week)	1
Tony n Tina's Wedding (Thursday-Sunday each week)	2
01-04 UK Open Pool Championship	3
02 FIH ProLeague England v China Women	6
03 Burna Boy: Love, Damini Tour	9
03 FIH ProLeague England v India Women	6

04 FIH ProLeague England v Belgium Men & Women	6
04 Nightrider	7
05 London Pulse v Saracens Mavericks	3
11 Netball Super League Grand Final 2023	3
14 Chase The Sun	10
16 FIH ProLeague England v Germany Women	6
17 FIH ProLeague England v Germany Men	6
18 FIH ProLeague England v USA v Spain Men & Women	6
19 FIH ProLeague England v Germany Women	6
20 FIH ProLeague England v Germany Men	6
21 FIH ProLeague England v Spain Men & Women	6
23-24 Stoomfest	4
24 Lee Valley VeloPark Run	7
24-25 Major League Baseball: Chicago Cubs v St Louis Cardinals	9
25-30 International Gay & Lesbian Aquatics Championships	8

* Hackney Half on 21 May and Ride London on 28 May are not coming through the Park but will close roads in the local area. Please check online for latest information.

Event venues - 1 ABBA Arena; 2 ArcelorMittal Orbit; 3 Copper Box Arena; 4 Hackney Bridge; 5 Here East; 6 Lee Valley Hockey and Tennis Centre; 7 Lee Valley VeloPark; 8 London Aquatics Centre; 9 London Stadium; 10 Park; 11 Off Park.

Stay up to date with news and information:

Sign up to receive our regular e-newsletter at: [QueenElizabethOlympicPark.co.uk/subscribe](https://www.queenelizabetholympicpark.co.uk/subscribe)



Park News is brought to you by the London Legacy Development Corporation, the organisation responsible for the planning, development, management and maintenance of Queen Elizabeth Olympic Park. It is our newsletter for people living and working near the Park. © 2023 London Legacy Development Corporation.

Park HQ: 0300 201 201

Customer service helpline: 0203 288 1800
customerservices@queenelizabetholympicpark.co.uk